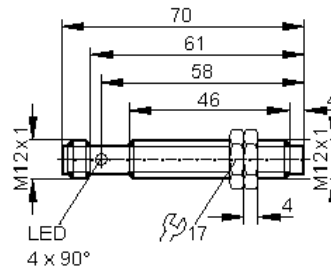

**IF5904**

IFK4004-CPKG/US  
Metal thread M12 x 1  
Plug and socket

Sensing range 4mm [nf]  
non-flush mountable

**CE**
**Electrical design**
**Output**
**DC PNP**
**complementary**

Operating voltage [V]

10...36 DC

Current rating [mA]

250

Short-circuit protection

pulsed

Reverse polarity protection

yes

Overload protection

yes

Voltage drop [V]

&lt; 2.5

Current consumption [mA]

&lt; 15 (24 V)

Real sensing range [mm]

4 ± 10 %

Operating distance [mm]

0...3.25

Switch-point drift [% / Sr]

-10...10

Hysteresis [% / Sr]

1...15

Switching frequency [Hz]

1400

Correction factors

 mild steel = 1 / stainless steel approx. 0.7 / brass approx. 0.5 / Al approx. 0.4 /  
Cu approx. 0.3

Operating temperature [°C]

-25...80

Protection

IP 67

EMC

EN 60947-5-2

Housing material

 brass white bronze coated  
active face: CO-PC

Function display

Switching status LED

yellow (4 x 90°)

Connection

M12 connector

Wiring

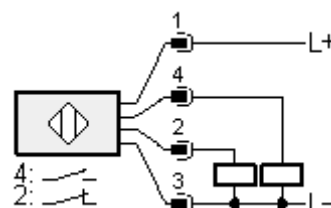

Accessories (included)

2 lock nuts